

# Initial R™: Single use distal radius sterile kit

## Initial R™ kits content



### Indications:

The implants of the Initial R™ range are intended for the fixation of intra and extra-articular fractures as well as distal radius osteotomies in adults.

### Contraindications :

- Serious vascular deterioration, bone devitalization,
- Pregnancy.
- Acute or chronic local or systemic infections.
- Lack of musculo-cutaneous cover, severe vascular deficiency affecting the concerned area.
- Insufficient bone quality preventing a good fixation of the implants into the bone,
- Muscular deficit, neurological deficiency or behavioral disorders, which could submit the implant to abnormal mechanical strains.
- Allergy to one of the materials used or sensitivity to foreign bodies.
- Serious problems of non-compliance, mental or neurological disorders, failure to follow post-operative care recommendations.
- Unstable physical and/or mental condition.

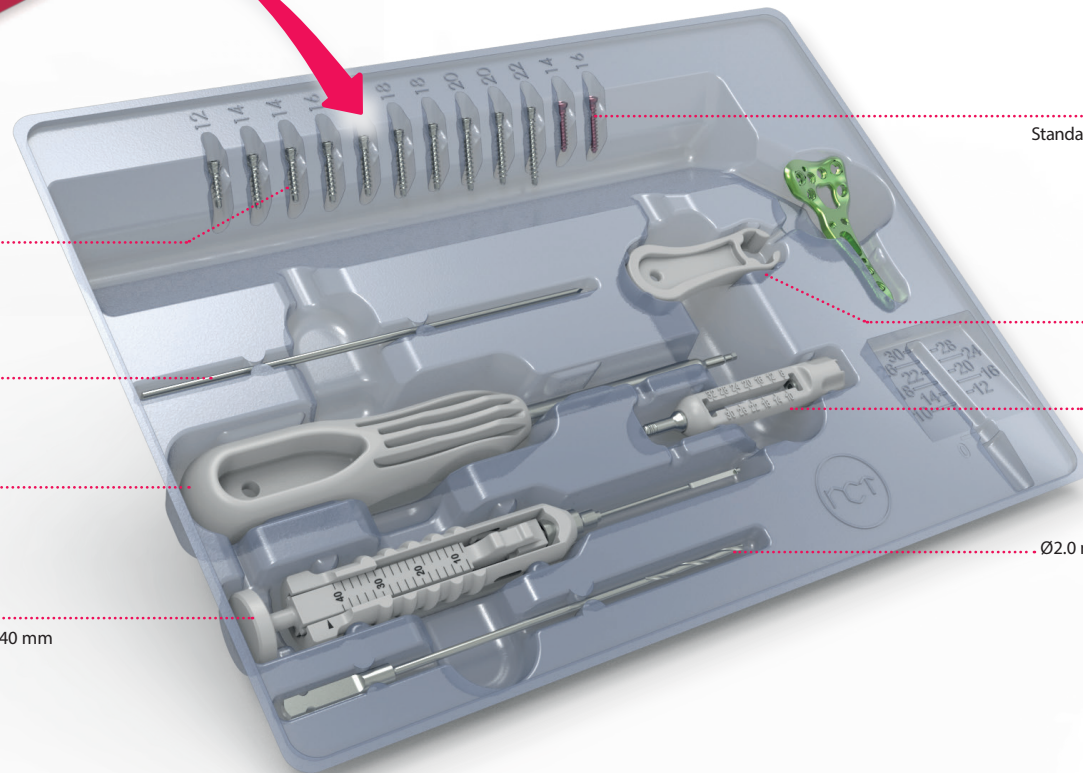

**SDT2.8Lxx**  
Locking screws - Ø2.8 mm  
Not anodized

Pins  
Ø1.4 L120 mm

2.0 mm hexagonal  
prehensors screwdriver

Length gauge  
for Ø2.4 and 2.8 mm screws - L 8-40 mm

**CT2.8Lxx**  
Standard cortical screws - Ø2.8 mm  
Pink anodized

Handle  
for guide gauge

Ø2.0 mm threaded guide  
gauge for Ø2.8 mm screws

Ø2.0 mm quick coupling drill bit -  
L125 mm



NEW CLIP-TECHNICS



# Initial R™ kits references



Precontoured plates  
with polyaxial locking fixation  
Narrow head  
Size 1 - Step one

KIT-RN1G_V2 or KIT-RN1D*		
Distal radius kit - Narrow head - Short - Left or right		
Ref.	Description	Qty
DTxVPN1	Polyaxial plate for distal radius - Narrow head - Short - (left or right)	1
SDT2.8L12	Ø2.8 mm locking screw - L 12 mm	2
SDT2.8L14	Ø2.8 mm locking screw - L 14 mm	2
SDT2.8L16	Ø2.8 mm locking screw - L 16 mm	2
SDT2.8L18	Ø2.8 mm locking screw - L 18 mm	2
SDT2.8L20	Ø2.8 mm locking screw - L 20 mm	1
CT2.8L12	Ø2.8 mm standard cortical screw - L 12 mm	1
CT2.8L14	Ø2.8 mm standard cortical screw - L 14 mm	1

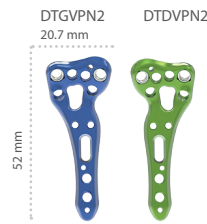

Precontoured plates  
with polyaxial locking fixation  
Narrow head  
Size 2

KIT-RN2G_V2 or KIT-RN2D*		
Distal radius kit - Narrow head - Left or right		
Ref.	Description	Qty
DTxVPN2	Polyaxial plate for distal radius - Narrow head - (left or right)	1
SDT2.8L12	Ø2.8 mm locking screw - L 12 mm	2
SDT2.8L14	Ø2.8 mm locking screw - L 14 mm	2
SDT2.8L16	Ø2.8 mm locking screw - L 16 mm	2
SDT2.8L18	Ø2.8 mm locking screw - L 18 mm	2
SDT2.8L20	Ø2.8 mm locking screw - L 20 mm	1
SDT2.8L22	Ø2.8 mm locking screw - L 22 mm	1
CT2.8L12	Ø2.8 mm standard cortical screw - L 12 mm	1
CT2.8L14	Ø2.8 mm standard cortical screw - L 14 mm	1

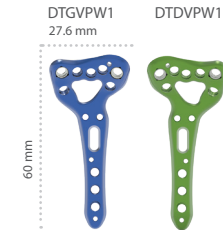

Precontoured plates  
with polyaxial locking fixation  
Wide head  
Size 1

KIT-RW1G or KIT-RW1D*		
Distal radius kit - Wide head - Left or right		
Ref.	Description	Qty
DTxVPW1	Polyaxial plate for distal radius - Wide head - (left or right)	1
SDT2.8L14	Ø2.8 mm locking screw - L 14 mm	2
SDT2.8L16	Ø2.8 mm locking screw - L 16 mm	3
SDT2.8L18	Ø2.8 mm locking screw - L 18 mm	3
SDT2.8L20	Ø2.8 mm locking screw - L 20 mm	3
SDT2.8L22	Ø2.8 mm locking screw - L 22 mm	2
SDT2.8L24	Ø2.8 mm locking screw - L 24 mm	1
CT2.8L16	Ø2.8 mm standard cortical screw - L 16 mm	1



Precontoured plates  
with polyaxial locking fixation  
Standard head  
Size 1 - Step one

KIT-RS1G_V2 or KIT-RS1D*		
Distal radius kit - Standard head - Short - Left or right		
Ref.	Description	Qty
DTxVPS1	Polyaxial plate for distal radius - Standard head - Short - (left or right)	1
SDT2.8L12	Ø2.8 mm locking screw - L 12 mm	2
SDT2.8L14	Ø2.8 mm locking screw - L 14 mm	2
SDT2.8L16	Ø2.8 mm locking screw - L 16 mm	2
SDT2.8L18	Ø2.8 mm locking screw - L 18 mm	2
SDT2.8L20	Ø2.8 mm locking screw - L 20 mm	1
CT2.8L14	Ø2.8 mm standard cortical screw - L 14 mm	1
CT2.8L16	Ø2.8 mm standard cortical screw - L 16 mm	1



Precontoured plates  
with polyaxial locking fixation  
Standard head  
Size 2

KIT-RS2G_V2 or KIT-RS2D*		
Distal radius kit - Standard head - Left or right		
Ref.	Description	Qty
DTxVPS2	Polyaxial plate for distal radius - Standard head - (left or right)	1
SDT2.8L12	Ø2.8 mm locking screw - L 12 mm	1
SDT2.8L14	Ø2.8 mm locking screw - L 14 mm	2
SDT2.8L16	Ø2.8 mm locking screw - L 16 mm	2
SDT2.8L18	Ø2.8 mm locking screw - L 18 mm	2
SDT2.8L20	Ø2.8 mm locking screw - L 20 mm	2
SDT2.8L22	Ø2.8 mm locking screw - L 22 mm	1
CT2.8L14	Ø2.8 mm standard cortical screw - L 14 mm	1
CT2.8L16	Ø2.8 mm standard cortical screw - L 16 mm	1



Precontoured plates  
with polyaxial locking fixation  
Standard head  
Size 3

KIT-RS3G_V2 or KIT-RS3D*		
Distal radius kit - Standard head - Long - Left or right		
Ref.	Description	Qty
DTxVPS3	Polyaxial plate for distal radius - Standard head - Long - (left or right)	1
SDT2.8L12	Ø2.8 mm locking screw - L 12 mm	3
SDT2.8L14	Ø2.8 mm locking screw - L 14 mm	4
SDT2.8L16	Ø2.8 mm locking screw - L 16 mm	3
SDT2.8L18	Ø2.8 mm locking screw - L 18 mm	2
SDT2.8L20	Ø2.8 mm locking screw - L 20 mm	2
SDT2.8L22	Ø2.8 mm locking screw - L 22 mm	1
CT2.8L14	Ø2.8 mm standard cortical screw - L 14 mm	2
CT2.8L16	Ø2.8 mm standard cortical screw - L 16 mm	1

\* Each kit includes one plate (left or right).

NB : Additional sterile screws can be ordered separated (Supplemental sterile screw caddy).



NEWCLIP TECHNICS  
PA de la Lande Saint Martin - 45 rue des Garotières  
44115 Haute Goulaine (France)  
Tél. : +33 (0)2 28 21 37 12 - Fax : +33 (0)2 40 63 68 37  
orders@newcliptechnics.com - www.newcliptechnics.com

NEWCLIP USA  
642 Larkfield Center  
Santa Rosa CA 95403, USA  
Phone : +1 707 230 5078  
customerservice@newclipusa.com - www.newclipusa.com

The information presented in this brochure is intended to demonstrate a Newclip Technics product. Always refer to the package insert, product label and/or user instructions before using any Newclip Technics product. Surgeons must always rely on their own clinical judgment when deciding which products and techniques to use with their patients. Products may not be available in all markets. Product availability is subject to the regulatory or medical practices that govern individual markets. Please contact your Newclip Technics representative if you have questions about the availability of Newclip Technics products in your area.

